

REVISED PLAN

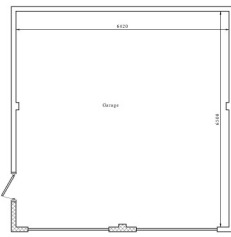
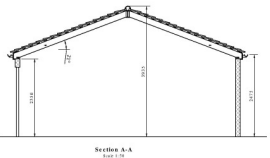

Minimum to finish and size of garage	11'0" x 10'0"
Minimum to finish and size of garage	10'0" x 9'0"
Minimum to finish and size of garage to interior walls	10'0" x 9'0"
Garage height to ceiling	7'6"
Garage height to floor	7'6"

Office: Gravica, Inc.
1000 Old Portway, St. Nicholas Street
Nashua, NH

Gravica

Gravica, Inc.
1000 Old Portway, St. Nicholas Street
Nashua, NH 03081-1000
www.gravica.com
603.882.2222
603.882.2223
603.882.2224
603.882.2225
603.882.2226
603.882.2227
603.882.2228
603.882.2229
603.882.2230

Preliminary

New Garage Plan & Elevations

DATE: 12/15/16
15sw412.101.0